

EK2

WITH CLAMPING HUB 6 - 2,150 Nm

PROPERTIES



FEATURES

- ▶ easy mounting
- ▶ highly concentric assembly
- ▶ vibration damping

DESIGN

Two concentrically machined hubs with curved jaws and clamping screws.

MATERIAL

- ▶ **Hubs:** up to size 450 high strength aluminum; size 800 steel
- ▶ **Elastomer:** wear resistant thermally stable TPU

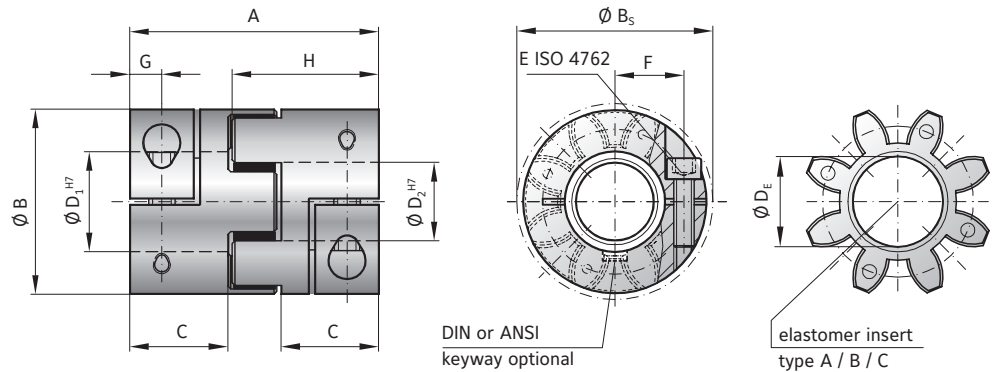

MODEL EK2

| SIZE | 20 | | | 60 | | | 150 | | | 300 | | | 450 | | | 800 | | | | | |
|---|-----------|----|----|--------|-----|----|---------|-----|----|---------|-----|-----|---------|------|-----|---------|------|-----|---------|--|--|
| Type (Elastomer insert) | A | B | C | A | B | C | A | B | C | A | B | C | A | B | C | A | B | C | | | |
| Rated torque (Nm) T_{KN} | 17 | 21 | 6 | 60 | 75 | 20 | 160 | 200 | 42 | 325 | 405 | 84 | 530 | 660 | 95 | 950 | 1100 | 240 | | | |
| Max. torque* (Nm) T_{Kmax} | 34 | 42 | 12 | 120 | 150 | 35 | 320 | 400 | 85 | 650 | 810 | 170 | 1060 | 1350 | 190 | 1900 | 2150 | 400 | | | |
| Overall length (mm) | A | | | 78 | | | 90 | | | 114 | | | 126 | | | 162 | | | | | |
| Outside diameter (mm) | B | | | 56 | | | 66.5 | | | 82 | | | 102 | | | 136.5 | | | | | |
| Outside diameter with screw head (mm) | B_s | | | 57 | | | 68 | | | 85 | | | 105 | | | 139 | | | | | |
| Mounting length (mm) | C | | | 30 | | | 35 | | | 45 | | | 50 | | | 65 | | | | | |
| Inside diameter range H7 (mm) | $D_{1/2}$ | | | 8 - 25 | | | 12 - 32 | | | 19 - 36 | | | 20 - 45 | | | 28 - 60 | | | 35 - 80 | | |
| Inside diameter of elastomer (mm) | D_E | | | 19.2 | | | 26.2 | | | 29.2 | | | 36.2 | | | 46.2 | | | 60.5 | | |
| Clamping screw (ISO 4762) | E | | | M5 | | | M6 | | | M8 | | | M10 | | | M12 | | | M16 | | |
| Tightening torque of the clamping screw (Nm) | E | | | 8 | | | 15 | | | 35 | | | 70 | | | 120 | | | 290 | | |
| Distance between centers (mm) | F | | | 15.5 | | | 21 | | | 24 | | | 29 | | | 38 | | | 50.5 | | |
| Distance (mm) | G | | | 8.5 | | | 10 | | | 12 | | | 15 | | | 17.5 | | | 23 | | |
| Hub length (mm) | H | | | 39 | | | 46 | | | 52.5 | | | 66 | | | 73 | | | 93.5 | | |
| Moment of inertia per hub (10^{-3} kgm^2) J_1/J_2 | 0.016 | | | 0.05 | | | 0.13 | | | 0.4 | | | 0.9 | | | 9.5 | | | | | |
| Approx. weight (kg) | 0.15 | | | 0.35 | | | 0.6 | | | 1.1 | | | 1.7 | | | 10 | | | | | |
| Speed standard (min^{-1}) | 12,500 | | | 11,000 | | | 10,000 | | | 9,000 | | | 8,000 | | | 4,000 | | | | | |
| Speed balanced (10^3 min^{-1}) | 45 | 60 | 35 | 31 | 31 | 25 | 22 | 26 | 18 | 22 | 26 | 16 | 16 | 17 | 12 | 13 | 13 | 8 | | | |

For information on shaft misalignment, torsional stiffness, and other details about the elastomer inserts see handbook precision couplings pages 72 + 73.

* Maximum transmittable torque of the clamping hub depends on the bore diameter

| Size | Ø 8 | Ø 16 | Ø 19 | Ø 25 | Ø 30 | Ø 32 | Ø 35 | Ø 45 | Ø 50 | Ø 55 | Ø 60 | Ø 65 | Ø 70 | Ø 75 | Ø 80 |
|------|-----|------|------|------|------|------|------|------|------|------|------|------|------|------|-------|
| 20 | 20 | 35 | 45 | 60 | | | | | | | | | | | |
| 60 | | 50 | 80 | 100 | 110 | 120 | | | | | | | | | |
| 150 | | | 120 | 160 | 180 | 200 | 220 | | | | | | | | |
| 300 | | | 200 | 230 | 300 | 350 | 380 | 420 | | | | | | | |
| 450 | | | | | 420 | 480 | 510 | 600 | 660 | 750 | 850 | | | | |
| 800 | | | | | | | 700 | 750 | 800 | 835 | 865 | 900 | 925 | 950 | 1,000 |

Higher torque possible with keyways