

Pulse counters, electronic

LCD modules	Adding, 6 digits (DC)	192
--------------------	------------------------------	------------



Type 192 is a single channel counter module for PCB mounting, with a large voltage range of 8 up to 28 V DC and a 6-digit LCD display.

Extremely robust as a result of its wide temperature range, the module is ideally suited for use in many application areas.



DC 8 ... 28 V	max. 100 Hz	PNP	000000	-40°...+80°C	7 LCDs	12345 00000
Supply voltage	Max. count frequency	Input type	High shock resistance	Temperature range	PCB mount	Electrical reset

Powerful

- Count frequency up to 100 Hz.
- 6-digits LCD display, 5 mm high.
- Low operating current.
- Wide operating voltage and temperature range.
- High shock and vibration resistance.

Simple

- Non-volatile memory (no battery).
- Single channel count input.
- Electrical reset.
- Very high reliability.
- Small size and very competitive price.

Order no.					
Supply voltage	Order no.	Art. no.	Delivery specification		
8 ... 28 V DC	6.192.012.H00	162 135	<ul style="list-style-type: none"> · LCD counter module type 192 · Operating instructions 		

1) Stock types.

Pulse counters, electronic

LCD modules	Adding, 6 digits (DC)	192
--------------------	------------------------------	------------

Technical data

General technical data	
Display	6 digits, LCD display, figure height 5 mm [0.20"]
Data backup	EEPROM
Memory	CMOS EEPROM. non-volatile memory data backup up to 10 years (without battery)
Operating / working / storage temperature	-40 °C ... +85 °C [-40 °F ... +185 °F] (non-condensing)
Humidity	95 % rel +32 °C [+90 °F] for 2 hours

Inputs	
Count input max. counting frequency	8 ... 28 V DC 100 Hz
Reset input pulse length	8 ... 28 V DC min. 500 msec

Approvals	
CE compliant in accordance with	
EMC Directive	2014/30/EU
RoHS Directive	2011/65/EU

Electrical characteristics	
Supply voltage	8 ... 28 V DC
Current consumption	max. 3 mA at 4.5 V DC 10 mA at 28 V DC

The module must be protected against inductive voltage spikes and high energy noise interference.

Mechanical characteristics	
Housing	dimensions 18.4 x 32.4 mm [0.72 x 1.28"] color black
Weight	approx. 8 g [0.28 oz]
Vibration resistance acc. to EN 60068-2-6	10 ... 80 m/s ² , 10 ... 75 Hz

Dimensions

Dimensions in mm [inch]

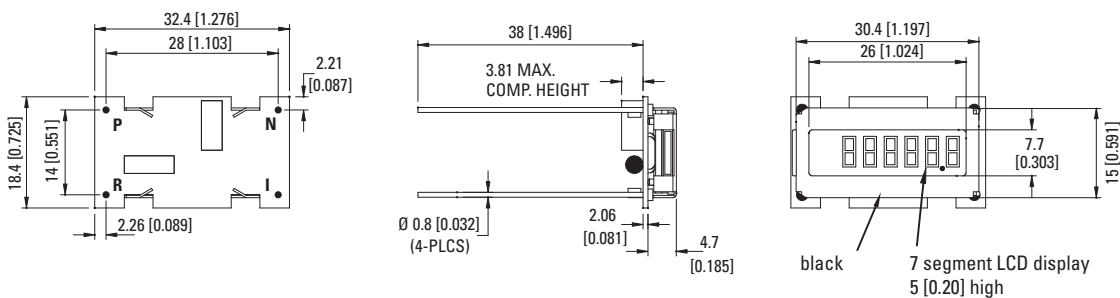

Terminal assignment

